

BRUNTON

RESIDENTIAL



SOUTH ROAD, LONGHORSLEY, MORPETH, NE65

Offers Over £300,000

BRUNTON

RESIDENTIAL





BRUNTON

RESIDENTIAL



BRUNTON

RESIDENTIAL



FULLY REFURBISHED | STONE BUILT PERIOD DETACHED | GARAGE AND GARDENS

Available with no upper chain, this spacious detached stone build, sits in a prime position on South Road, Longhorsley. The property is thought to be around 300 years old and boasts a period feel throughout with fresh, bright and airy rooms to compliment. A commemorative plaque confirms this is where suffragette, Emily Wilding Davison lived with her parents and the very house in which she left to attend the Epson Derby in 1913. Longhorsely is a pretty village with a range of local amenities including local shops, a village hall, a successful primary school and pub/restaurant. Morpeth town is only a 7-mile drive, where you will find an array of local bars, restaurants, a great range of shops and leisure facilities. The property is extremely convenient for those who need to commute with the A697 linking you to both Morpeth, Alnwick and Newcastle.

BRUNTON

RESIDENTIAL



BRUNTON

RESIDENTIAL

The property was purchased by the current owners requiring modernisation and has undertaken a full refurbishment throughout. Accommodation comprises of - generous entrance hallway, downstairs shower room, large bright and airy lounge with light laminate flooring, impressive brand-new kitchen which has been fitted with a range of wall and base units, offering an abundance of storage. Appliances include electric oven and hob and dishwasher. To the rear of the kitchen, you have a separate utility space, ideal for extra storage space.

To the upper floor of the accommodation, you have four generous bedrooms, all of which have been carpeted throughout and finished with fresh décor. Two of the bedrooms also benefit from their own en-suites with mains powered showers. The good sized family bathroom has been beautifully finished with W.C., hand basin, walk-in shower and separate bath tub.

Externally the former garage is to the rear, which now forms the utility room/boiler room storage. Common land parking at the rear leading to the garage. The property enjoys it's own garden to the rear offering a secluded, private space to enjoy.



BRUNTON

RESIDENTIAL

TENURE : Freehold

LOCAL AUTHORITY : Northumberland CC

COUNCIL TAX BAND :

EPC RATING : E

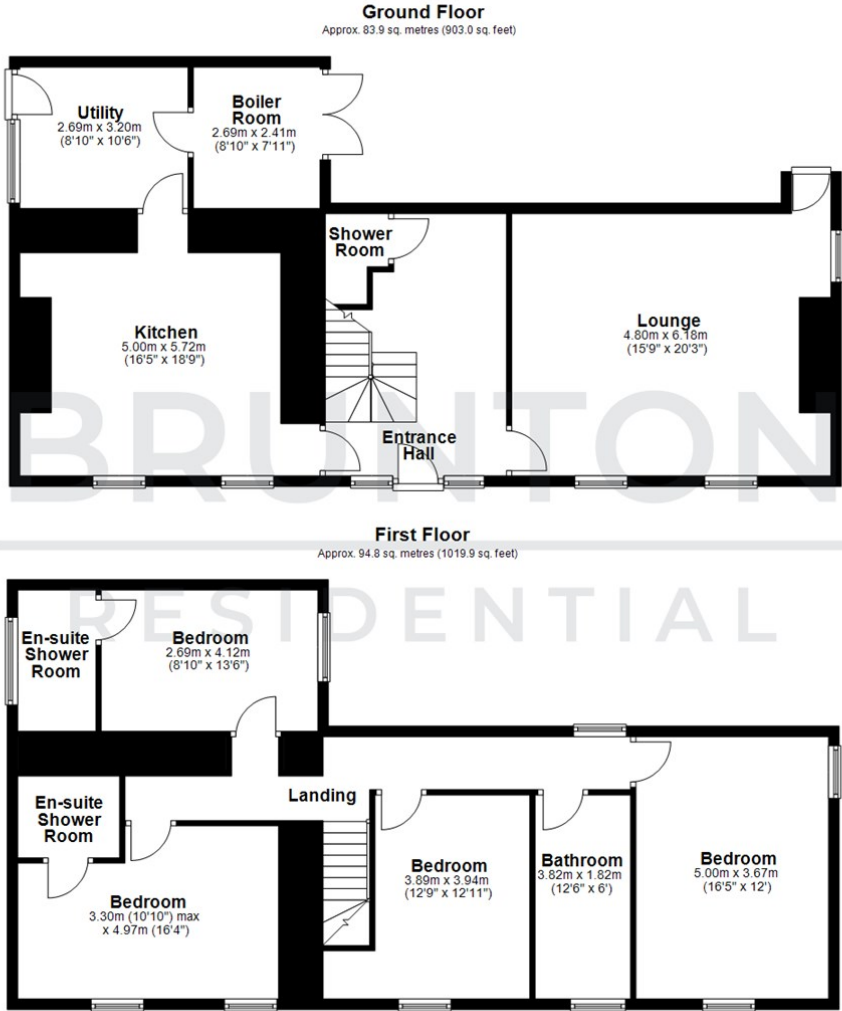

All measurements are approximate and are for illustration only.
Plan produced using PlanUp.

